



### Laser 3000™ Head Position

Please note the **correct** way to attach the head to the Laser 3000™.

Always make sure that the unit is **switched off** if you need to attach or remove the head.

If you are attaching the head, ensure that the head is in the 10 o'clock position to begin with and then rotate it clockwise so that the notch is in the 12 o'clock position. This is with the laser head facing you.

It is important for the head to be in this position in order for the Laser 3000™ to operate. Otherwise, damage can be done to the internal circuitry.

If you have any questions, please contact LasereX on [sales@laser3000.net](mailto:sales@laser3000.net)

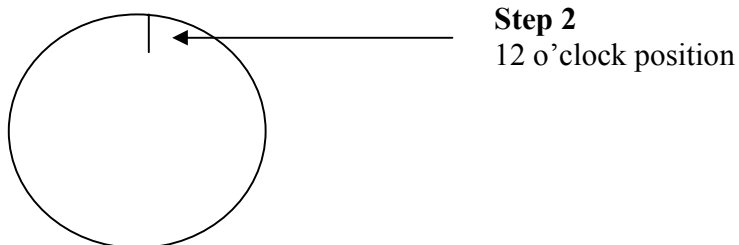
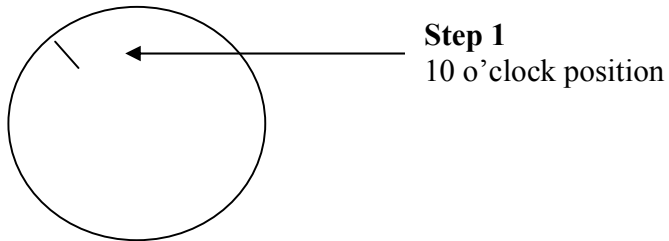

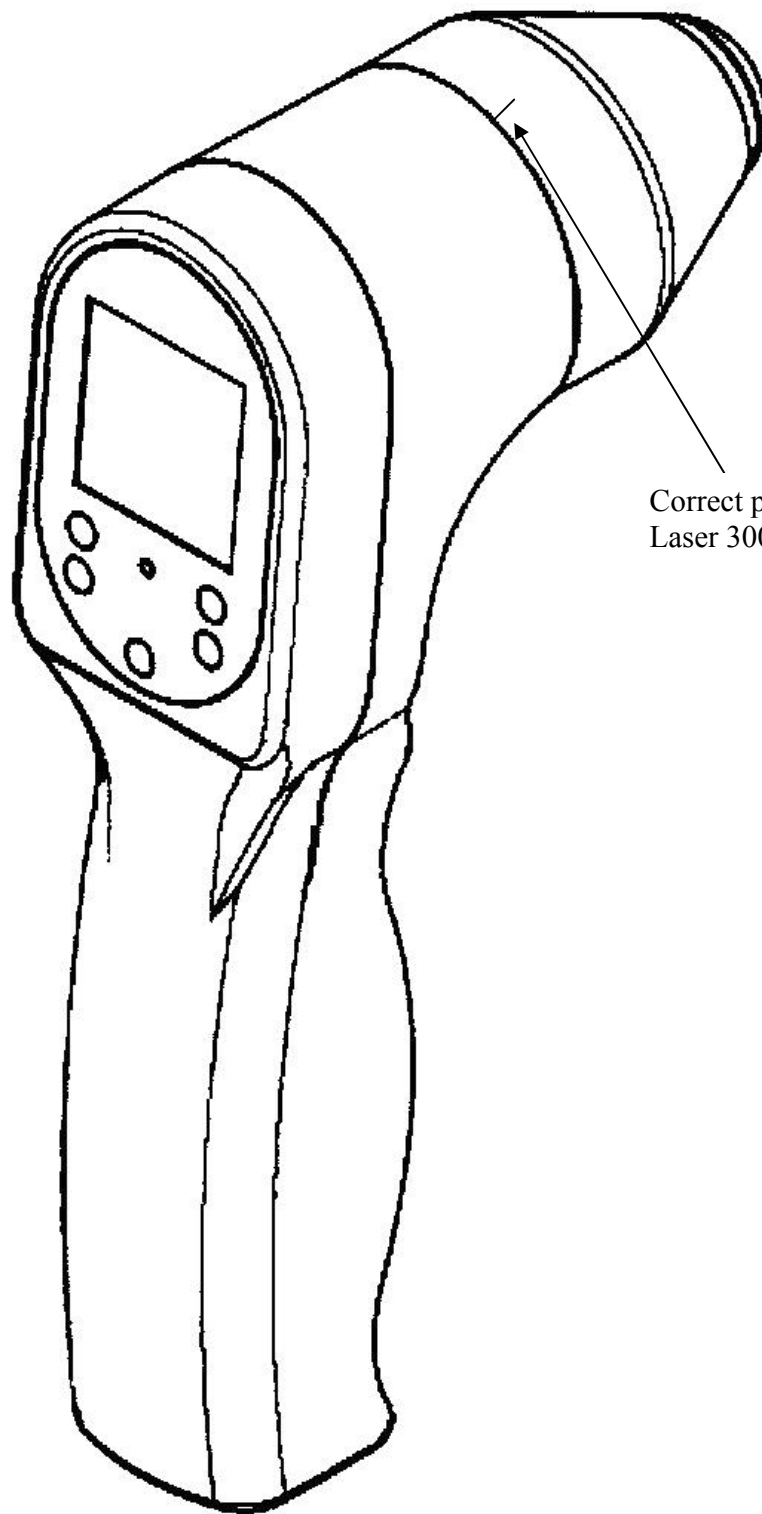

Correct position of  
Laser 3000™ head